

PenCycle You return it
We recycle it

Your pre-filled
Novo Nordisk pens
can now be recycled!



Brought to you by:

novo nordisk®



You return it
We recycle it

Welcome to **PenCycle**,
the pre-filled pen recycling
initiative, brought to you
by **Novo Nordisk**.

We are asking you to return your empty
Novo Nordisk pens so we can recycle them.

This leaflet contains all the information you need
to start **PenCycling** today.





How can I PenCycle?

PenCycling could not be simpler, and is **completely free of charge**.

To get started, collect a **PenCycle return box** from your nearest participating pharmacy, or order some online on our website:

www.pen-cycle.co.uk



Then:

1

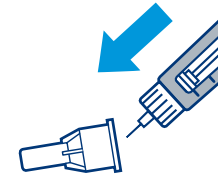

Remove the needle from your empty pen and dispose of it carefully in your normal way (do not put the needle in the PenCycle return box)

2

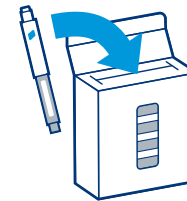

Drop your empty pen in your return box

3

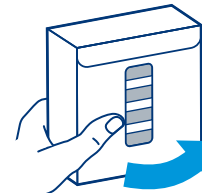

When the return box is full, either return it to your nearest participating pharmacy or mail it back to us free of charge



Please always make sure your pen is **empty** before you drop it in the box.



Removing the needle from your empty pen before you drop your pen in the return box is really important – your pen **cannot** be recycled if the needle is still attached.

12

Your PenCycle return box can hold a **maximum of 12 pens**.



Where can I PenCycle?

You can drop off your full return box at any participating pharmacy. You can find your nearest participating pharmacies by having a look on our website:

www.pen-cycle.co.uk

If you can't make it to a pharmacy, don't worry! Every return box has a FREEPOST Royal Mail address printed on the back so you can mail them back to us at **Novo Nordisk** from any post box or post office, free of charge.





Why PenCycle?

At **Novo Nordisk**, we're committed to environmental change. We have ambitious targets as part of our "**Circular for Zero**" initiative, including:



Using **100%** renewable energy across our global production (which we have already achieved)



Re-designing both our existing and future products to reduce our waste



Working together with our supply partners to make our processes more environmentally friendly

And now, we want to make an even bigger difference by including your empty pens.

Every year in the UK, your pens are among **23 million** medical pens that end up incinerated or sent to landfill as, until now, there has not been a viable recycling alternative. This is not sustainable. At **Novo Nordisk**, as the people who make the pens you use, we want to play our part in fixing this.

circular
FOR **zero**

23
million
empty pens going
to waste



We have developed a **new, innovative process** that lets us recycle our pre-filled pens after use.

Your pre-filled pen contains important medicine and is with you wherever you go. Because of this, it is made from high-quality, long-lasting materials which are too good to waste. By finding new ways to reuse them, we can help put an end to the unsustainable use of earth's natural resources.

But we can't do this without you.

You return it, **we recycle it.**

Frequently asked questions

Who is behind PenCycle?

Novo Nordisk are a global healthcare company, founded in Denmark in 1923. Our purpose at **Novo Nordisk UK** is to defeat diabetes, obesity, rare blood and hormone disorders, to improve the lives of millions of people in the UK. Today, we supply over half the world's insulin.

Everything we do is based on acting socially, environmentally and financially responsibly with planned zero environmental impact. We call this "**Circular for Zero**".

We are proud to be working together with a range of organisations providing services in the UK healthcare sector to bring **PenCycle** to life.

Where can I see if the pen I am using is from Novo Nordisk?

This information can be found on the label of your pen. If you're unsure, you can always ask at the pharmacy.

Can I return other medical devices with my Novo Nordisk pens as part of PenCycle?

Other medical devices, for example insulin vials, insulin pumps and pens from other companies, cannot currently be recycled as part of **PenCycle**, but our goal is to find an industry-wide solution. Only pre-filled **Novo Nordisk** pens can be returned to us in the supplied, dedicated **PenCycle return box**, which you can pick up from participating pharmacies.

Can I drop off my pens at any pharmacy?

You can drop off empty pens in a return box at any **participating** pharmacy. To find your nearest participating pharmacy, please check our website: www.pen-cycle.co.uk

Can I return my empty pens to my GP or hospital clinic?

No, pens can only be recycled through the **PenCycle** initiative. **PenCycle** will use existing logistical routes to minimise the environmental impact, and GP surgeries, secondary care clinics and hospital clinics are not currently part of these routes.

What will happen to the pens I return?

Every pre-filled **Novo Nordisk** pen returned to us through **PenCycle** will be recycled and given new purpose. We have already started this process in Denmark, where we have shown the positive impact repurposing these materials can have:

- The plastic has gone into new furniture
- The glass has been repurposed into lightbulbs



How will I know my pen will not be wasted?

Every pen that is returned to us will be sent back to our specialist facility in Denmark to be recycled. This process will use existing logistical routes to minimise the environmental impact. Every shipment of pens will be tracked and recorded to make sure none of them end up in landfill or incinerated.

Why is PenCycling better than my regular disposal route?

Usually, empty medical devices like your pen are sent to landfill or destroyed as hazardous waste through incineration. Incineration uses a lot of energy and leaves some plastic waste behind. By **PenCycling**, you are making sure your pen is repurposed in an environmentally friendly way.

Can the return boxes be recycled?

Yes. These are made from recyclable materials and will be recycled as part of the **PenCycle** process.

Will pharmacies receive money to collect pens?

No. Pharmacists have been invited to participate in the initiative to support environmental targets, but they will not receive money to collect pens.

Contact us

If you have any questions at all, or would like more information about **PenCycle**, please visit:

www.pen-cycle.co.uk



Why not ask the Novo Nordisk Automated On-demand Medical Information (**NAOMI**) chat service. NAOMI is an automated system and is available 24 hours a day.

Ask NAOMI:

www.novonordisk-naomi.co.uk

Alternatively, please contact Novo Nordisk via
www.novonordisk.co.uk/contact-us

Returning your pens only takes a few minutes but will have an impact that lasts years. From this point on, every pen you return to us will be reclaimed and repurposed. Every pen you return will avoid ending up in landfill or being incinerated.

Together we can
give empty pens
new purpose.



www.pen-cycle.co.uk

PenCycle

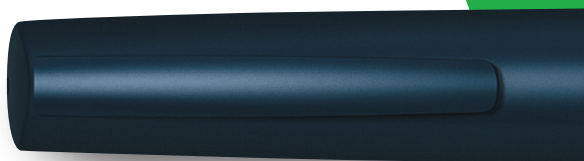

♻️ This leaflet is made from recycled materials, and can be recycled again after use

The Apis Bull logo is a registered trademark owned by Novo Nordisk A/S